

PARCEL 408

TEMPORARY CONSTRUCTION EASEMENT BEING A PORTION OF THE  
HEREINAFTER DESCRIBED TRACT "X" LOCATED IN THE SOUTHEAST  
QUARTER OF THE SOUTHWEST QUARTER, SECTION 6, TOWNSHIP 26  
NORTH, RANGE 4 EAST, W.M., CITY OF SHORELINE, KING COUNTY,  
WASHINGTON; MORE PARTICULARLY DESCRIBED AS FOLLOWS:

ALL THAT PORTION OF TRACT "X" LYING EAST, SOUTH, AND EAST OF  
THE FOLLOWING DESCRIBED LINE: BEGINNING AT A POINT ON THE  
SOUTHERN BOUNDARY OF SAID TRACT "X" OPPOSITE ENGINEERS  
STATION 275+61, MORE OR LESS, 69.50 FEET WESTERLY MEASURED AT  
RIGHT ANGLES THEREFROM ON THE CENTERLINE OF AURORA AVENUE  
NORTH AS SHOWN ON THE RECORD OF SURVEY RECORDED UNDER  
AUDITOR'S FILE NUMBER 20080305900001, RECORDS OF KING COUNTY;  
THENCE NORTHERLY TO A POINT OPPOSITE ENGINEERS STATION  
275+74.00 ON SAID CENTERLINE AND 69.50 FEET WESTERLY  
THEREFROM; THENCE EASTERLY TO A POINT OPPOSITE ENGINEERS  
STATION 275+74.00 ON SAID CENTERLINE AND 67.00 FEET WESTERLY  
THEREFROM; THENCE NORTHERLY TO A POINT ON THE NORTHERN  
BOUNDARY OF SAID TRACT "X" OPPOSITE ENGINEERS STATION 278+50,  
MORE OR LESS, ON SAID CENTERLINE AND 67.00 FEET WESTERLY  
THEREFROM, AND THE TERMINUS OF THIS LINE.

CONTAINING 1,302 SQUARE FEET MORE OR LESS.

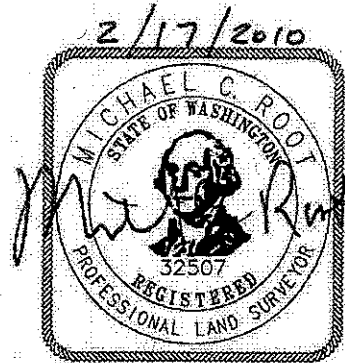

<b>INCA</b> INCA ENGINEERS INC.	<b>HDR</b> ENGINEERING INC.		<b>PARCEL 408</b> <b>AURORA AVE N</b> <b>RIGHT OF WAY</b>	<b>02/17/10</b>
------------------------------------	--------------------------------	---	---	-----------------

TRACT X

TRACTS 72 AND 73, RICHMOND HEIGHTS, ACCORDING TO THE PLAT THEREOF RECORDED IN VOLUME 18 OF PLATS, PAGE 77, IN KING COUNTY, WASHINGTON;

EXCEPT THAT PORTION CONVEYED TO THE STATE OF WASHINGTON FOR ROAD BY DEED RECORDED UNDER RECORDING NUMBER 2173656;

AND EXCEPT THAT PORTION CONDEMNED IN KING COUNTY SUPERIOR COURT CAUSE NUMBER 190508 FOR STATE ROAD NO. 1.



**PARCEL 408**

**AURORA AVE N  
RIGHT OF WAY**

**02/17/10**

## PARCEL 410

PERMANENT RIGHT-OF-WAY BEING A PORTION OF THE HEREINAFTER DESCRIBED TRACT "X" LOCATED IN THE NORTHEAST QUARTER OF THE SOUTHWEST QUARTER, SECTION 6, TOWNSHIP 26 NORTH, RANGE 4 EAST, W.M., CITY OF SHORELINE, KING COUNTY, WASHINGTON; MORE PARTICULARLY DESCRIBED AS FOLLOWS:

ALL THAT PORTION OF TRACT "X" LYING SOUTHEAST OF THE FOLLOWING DESCRIBED LINE: BEGINNING AT A POINT ON THE EASTERN BOUNDARY OF SAID TRACT "X" OPPOSITE ENGINEERS STATION 286+85.44 AND 60.00 WESTERLY MEASURED AT RIGHT ANGLES THEREFROM ON THE CENTERLINE OF AURORA AVENUE NORTH AS SHOWN ON THE RECORD OF SURVEY RECORDED UNDER AUDITOR'S FILE NUMBER 20080305900001, RECORDS OF KING COUNTY; THENCE ALONG A CURVE CONCAVE TO THE NORTHWEST HAVING A RADIUS OF 48.00 FEET, TO A POINT ON THE SOUTHERN BOUNDARY OF SAID TRACT "X" OPPOSITE ENGINEERS STATION 286+37, MORE OR LESS, AND 108.35 FEET WESTERLY THEREFROM, AND THE TERMINUS OF THIS LINE.

CONTAINING 367 SQUARE FEET MORE OR LESS.

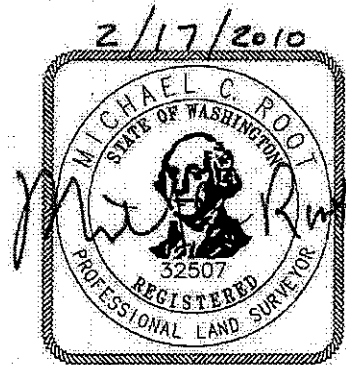

<b>INCA</b> <small>INCA ENGINEERS INC.</small>	<b>HDR</b> <small>ENGINEERING INC.</small>		<b>PARCEL 410</b> <b>AURORA AVE N</b> <b>RIGHT OF WAY</b>	<b>02/17/10</b>
---	---	---	---	-----------------

## PARCEL 410

TEMPORARY CONSTRUCTION EASEMENT BEING A PORTION OF THE  
HEREINAFTER DESCRIBED TRACT "X" LOCATED IN THE NORTHEAST  
QUARTER OF THE SOUTHWEST QUARTER, SECTION 6, TOWNSHIP 26  
NORTH, RANGE 4 EAST, W.M., CITY OF SHORELINE, KING COUNTY,  
WASHINGTON; MORE PARTICULARLY DESCRIBED AS FOLLOWS:

ALL THAT PORTION OF TRACT "X" LYING WITHIN THE FOLLOWING  
DESCRIBED LINE: BEGINNING AT A POINT THAT IS THE NORTHEAST  
CORNER OF SAID TRACT "X" OPPOSITE ENGINEERS STATION 287+59,  
MORE OR LESS, AND 60.00 WESTERLY MEASURED AT RIGHT ANGLES  
THEREFROM ON THE CENTERLINE OF AURORA AVENUE NORTH AS SHOWN  
ON THE RECORD OF SURVEY RECORDED UNDER AUDITOR'S FILE NUMBER  
20080305900001, RECORDS OF KING COUNTY; THENCE SOUTHERLY  
ALONG THE EASTERN BOUNDARY OF SAID TRACT "X" TO A POINT  
OPPOSITE ENGINEERS STATION 286+85.44 ON SAID CENTERLINE AND  
60.00 FEET WESTERLY THEREFROM; THENCE ALONG A CURVE CONCAVE  
TO THE NORTHWEST HAVING A RADIUS OF 48.00 FEET, TO A POINT  
ON THE SOUTHERN BOUNDARY OF SAID TRACT "X" OPPOSITE  
ENGINEERS STATION 286+37, MORE OR LESS, AND 108.35 FEET  
WESTERLY THEREFROM; THENCE WESTERLY ALONG SAID SOUTHERN  
BOUNDARY TO A POINT OPPOSITE ENGINEERS STATION 286+38.65 ON  
SAID CENTERLINE AND 272.78 FEET WESTERLY THEREFROM; THENCE  
NORTHERLY TO A POINT OPPOSITE ENGINEERS STATION 286+44.87 ON  
SAID CENTERLINE AND 272.73 FEET WESTERLY THEREFROM; THENCE  
EASTERLY TO A POINT OPPOSITE ENGINEERS STATION 286+44.46 ON  
SAID CENTERLINE AND 216.95 FEET WESTERLY THEREFROM; THENCE  
EASTERLY TO A POINT OPPOSITE ENGINEERS STATION 286+43.82 ON  
SAID CENTERLINE AND 128.46 FEET WESTERLY THEREFROM; THENCE  
NORTHERLY TO A POINT OPPOSITE ENGINEERS STATION 286+54.43 ON  
SAID CENTERLINE AND 128.39 FEET WESTERLY THEREFROM; THENCE  
EASTERLY TO POINT OPPOSITE ENGINEERS STATION 286+54.30 ON  
SAID CENTERLINE AND 110.70 FEET WESTERLY THEREFROM; THENCE  
SOUTHERLY TO A POINT OPPOSITE ENGINEERS STATION 286+43.69 ON  
SAID CENTERLINE AND 110.78 FEET WESTERLY THEREFROM; THENCE  
EASTERLY TO A POINT OPPOSITE ENGINEERS STATION 286+43.57 ON  
SAID CENTERLINE AND 94.33 FEET WESTERLY THEREFROM; THENCE  
NORTHEASTERLY TO A POINT OPPOSITE ENGINEERS STATION  
286+69.00 ON SAID CENTERLINE AND 69.50 FEET WESTERLY  
THEREFROM; THENCE NORTHERLY TO POINT ON THE NORTHERN  
BOUNDARY OF SAID TRACT "X" OPPOSITE ENGINEERS STATION  
287+59, MORE OR LESS, ON SAID CENTERLINE AND 69.50 FEET  
WESTERLY THEREFROM; THENCE EASTERLY ALONG SAID NORTHERN  
BOUNDARY TO THE POINT OF BEGINNING AND THE TERMINUS OF THIS  
LINE.

CONTAINING 2,426 SQUARE FEET MORE OR LESS.

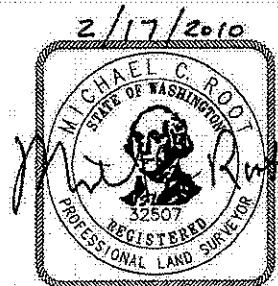

PARCEL 410

AURORA AVE N  
RIGHT OF WAY

02/17/10

TRACT "X"

LOT 2, KING COUNTY SHORT PLAT NO. 977039, RECORDED UNDER  
KING COUNTY RECORDING NUMBER 7803240941, BEING A PORTION OF  
TRACT 65, RICHMOND HIGHLANDS, ACCORDING TO THE PLAT THEREOF  
RECORDED IN VOLUME 18 OF PLATS, PAGE 77, IN KING COUNTY,  
WASHINGTON.



PARCEL 410

AURORA AVE N  
RIGHT OF WAY

02/17/10

## PARCEL 411

PERMANENT RIGHT-OF-WAY BEING A PORTION OF THE HEREINAFTER DESCRIBED TRACT "X" LOCATED IN THE NORTHEAST QUARTER OF THE SOUTHWEST QUARTER, SECTION 6, TOWNSHIP 26 NORTH, RANGE 4 EAST, W.M., CITY OF SHORELINE, KING COUNTY, WASHINGTON; MORE PARTICULARLY DESCRIBED AS FOLLOWS:

ALL THAT PORTION OF TRACT "X" LYING NORTH, EAST, NORTHEAST, AND EAST OF THE FOLLOWING DESCRIBED LINE: BEGINNING AT A POINT ON THE EASTERN BOUNDARY OF SAID TRACT "X" OPPOSITE ENGINEERS STATION 288+47.00 AND 60.00 WESTERLY MEASURED AT RIGHT ANGLES THEREFROM ON THE CENTERLINE OF AURORA AVENUE NORTH AS SHOWN ON THE RECORD OF SURVEY RECORDED UNDER AUDITOR'S FILE NUMBER 20080305900001, RECORDS OF KING COUNTY; THENCE WESTERLY TO A POINT OPPOSITE ENGINEERS STATION 288+47.00 ON SAID CENTERLINE AND 64.00 FEET WESTERLY THEREFROM; THENCE NORTHERLY TO A POINT OPPOSITE ENGINEERS STATION 288+70.00 ON SAID CENTERLINE AND 64.00 FEET WESTERLY THEREFROM; THENCE NORTHWESTERLY TO A POINT OPPOSITE ENGINEERS STATION 288+73.50 ON SAID CENTERLINE AND 68.50 FEET WESTERLY THEREFROM; THENCE NORTHERLY TO A POINT ON THE NORTHERN BOUNDARY OF SAID TRACT "X" OPPOSITE ENGINEERS STATION 288+80, MORE OR LESS, ON SAID CENTERLINE AND 68.50 FEET WESTERLY THEREFROM, AND THE TERMINUS OF THIS LINE.

CONTAINING 166 SQUARE FEET MORE OR LESS.

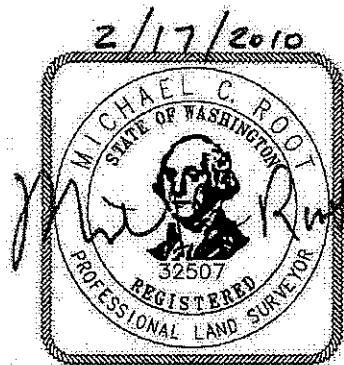

<b>INCA</b> <small>INCA ENGINEERS INC.</small>	<b>HDR</b> <small>ENGINEERING INC.</small>	 <b>SHORELINE</b>	<b>PARCEL 411</b> <b>AURORA AVE N</b> <b>RIGHT OF WAY</b>	<b>02/17/10</b>
---	---	----------------------	---	-----------------

## PARCEL 411

TEMPORARY CONSTRUCTION EASEMENT BEING A PORTION OF THE  
HEREINAFTER DESCRIBED TRACT "X" LOCATED IN THE NORTHEAST QUARTER  
OF THE SOUTHWEST QUARTER, SECTION 6, TOWNSHIP 26 NORTH, RANGE 4  
EAST, W.M., CITY OF SHORELINE, KING COUNTY, WASHINGTON; MORE  
PARTICULARLY DESCRIBED AS FOLLOWS:

ALL THAT PORTION OF TRACT "X" LYING SOUTH, WEST, SOUTHWEST,  
WEST, SOUTH, AND EAST OF THE FOLLOWING DESCRIBED LINE: BEGINNING  
AT A POINT ON THE EASTERN BOUNDARY OF SAID TRACT "X" OPPOSITE  
ENGINEERS STATION 288+47.00 AND 60.00 WESTERLY MEASURED AT RIGHT  
ANGLES THEREFROM ON THE CENTERLINE OF AURORA AVENUE NORTH AS  
SHOWN ON THE RECORD OF SURVEY RECORDED UNDER AUDITOR'S FILE  
NUMBER 20080305900001, RECORDS OF KING COUNTY; THENCE WESTERLY  
TO A POINT OPPOSITE ENGINEERS STATION 288+47.00 ON SAID  
CENTERLINE AND 64.00 FEET WESTERLY THEREFROM; THENCE NORTHERLY  
TO A POINT OPPOSITE ENGINEERS STATION 288+70.00 ON SAID  
CENTERLINE AND 64.00 FEET WESTERLY THEREFROM; THENCE  
NORTHWESTERLY TO A POINT OPPOSITE ENGINEERS STATION 288+73.50 ON  
SAID CENTERLINE AND 68.50 FEET WESTERLY THEREFROM; THENCE  
NORTHERLY TO A POINT ON THE NORTHERN BOUNDARY OF SAID TRACT "X"  
OPPOSITE ENGINEERS STATION 288+80, MORE OR LESS, ON SAID  
CENTERLINE AND 68.50 FEET WESTERLY THEREFROM; THENCE ALONG SAID  
NORTHERN BOUNDARY TO A POINT OPPOSITE ENGINEERS STATION 288+80,  
MORE OR LESS, ON SAID CENTERLINE AND 69.50 FEET WESTERLY  
THEREFROM; THENCE SOUTHERLY TO A POINT ON THE SOUTHERN BOUNDARY  
OF SAID TRACT "X" OPPOSITE ENGINEERS STATION 287+59, MORE OR  
LESS, ON SAID CENTERLINE AND 69.50 FEET WESTERLY THEREFROM, AND  
THE TERMINUS OF THIS LINE.

CONTAINING 980 SQUARE FEET MORE OR LESS.

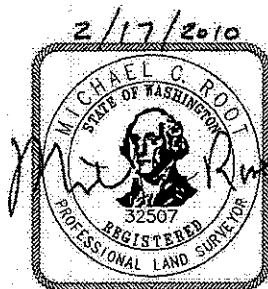

**INCA HR**  
INCA ENGINEERS INC. ENGINEERING INC.



**PARCEL 411**  
**AURORA AVE N**  
**RIGHT OF WAY**

**02/17/10**

TRACT "X"

LOT 1, KING COUNTY SHORT PLAT NO. 977039, RECORDED UNDER KING COUNTY RECORDING NUMBER 7803240941, BEING A PORTION OF TRACTS 64 AND 65, RICHMOND HIGHLANDS, ACCORDING TO THE PLAT THEREOF RECORDED IN VOLUME 18 OF PLATS, PAGE 77, IN KING COUNTY, WASHINGTON.

**INCA HDR**  
INCA ENGINEERS INC. ENGINEERING INC.



**PARCEL 411**

**AURORA AVE N  
RIGHT OF WAY**

**02/17/10**



PARCEL 454

PERMANENT RIGHT OF WAY BEING A PORTION OF THE HEREINAFTER DESCRIBED TRACT "X" LOCATED IN THE SOUTHWEST QUARTER OF THE SOUTHEAST QUARTER, SECTION 6, TOWNSHIP 26 NORTH, RANGE 4 EAST, W.M., CITY OF SHORELINE, KING COUNTY, WASHINGTON; MORE PARTICULARLY DESCRIBED AS FOLLOWS:

ALL THAT PORTION OF TRACT "X" LYING NORTHWEST, SOUTH AND WEST OF THE FOLLOWING DESCRIBED LINE: BEGINNING AT A POINT ON THE SOUTHERN BOUNDARY OF SAID TRACT "X" OPPOSITE ENGINEERS STATION 278+00, MORE OR LESS, AND 64.80 FEET EASTERLY MEASURED AT RIGHT ANGLES THEREFROM ON THE CENTERLINE OF AURORA AVENUE NORTH AS SHOWN ON THE RECORD OF SURVEY RECORDED UNDER AUDITOR'S FILE NUMBER 20080305900001, RECORDS OF KING COUNTY; THENCE NORTHEASTERLY TO A POINT OPPOSITE ENGINEERS STATION 278+23.00 ON SAID CENTERLINE AND 69.93 FEET EASTERLY THEREFROM; THENCE WESTERLY TO A POINT OPPOSITE ENGINEERS STATION 278+23.00 OF SAID CENTERLINE AND 53.50 FEET EASTERLY THEREFROM; THENCE NORTHERLY TO A POINT ON THE WESTERN BOUNDARY OF SAID TRACT "X" OPPOSITE ENGINEERS STATION 279+50, MORE OR LESS, ON SAID CENTERLINE AND 51.50 FEET EASTERLY THEREFROM AND THE TERMINUS OF THIS LINE.

CONTAINING 1,471 SQUARE FEET MORE OR LESS.



**INCA HDR**  
INCA ENGINEERS INC. ENGINEERING INC.



**PARCEL 454**

**AURORA AVE N  
RIGHT OF WAY**

**02/11/10**

PARCEL 454

TEMPORARY CONSTRUCTION EASEMENT BEING A PORTION OF THE  
HEREINAFTER DESCRIBED TRACT "X" LOCATED IN THE SOUTHWEST QUARTER  
OF THE SOUTHEAST QUARTER, SECTION 6, TOWNSHIP 26 NORTH, RANGE 4  
EAST, W.M., CITY OF SHORELINE, KING COUNTY, WASHINGTON; MORE  
PARTICULARLY DESCRIBED AS FOLLOWS:

ALL THAT PORTION OF TRACT "X" LYING WITHIN THE FOLLOWING  
DESCRIBED LINE: BEGINNING AT A POINT ON THE EAST BOUNDARY OF  
SAID TRACT "X" OPPOSITE ENGINEERS STATION 278+23.00 AND 69.93  
FEET EASTERLY MEASURED AT RIGHT ANGLES THEREFROM ON THE  
CENTERLINE OF AURORA AVENUE NORTH AS SHOWN ON THE RECORD OF  
SURVEY RECORDED UNDER AUDITOR'S FILE NUMBER 20080305900001,  
RECORDS OF KING COUNTY; THENCE NORTHEASTERLY ALONG SAID EAST  
BOUNDARY OF TRACT "X" TO A POINT OPPOSITE ENGINEERS STATION  
278+30.00 ON SAID CENTERLINE AND 71.48 FEET EASTERLY THEREOF;  
THENCE NORTHWESTERLY TO A POINT OPPOSITE ENGINEERS STATION  
278+40.00 ON SAID CENTERLINE AND 63.00 FEET EASTERLY THEREOF;  
THENCE NORTHERLY TO A POINT OF CURVATURE OPPOSITE ENGINEERS  
STATION 279+06.85 ON SAID CENTERLINE AND 63.00 FEET EASTERLY  
THEREOF; THENCE ALONG A TANGENT CURVE TO THE LEFT HAVING A  
RADIUS OF 11,517.13 FEET TO A POINT OPPOSITE ENGINEERS STATION  
279+50.00 ON SAID CENTERLINE AND 63.00 FEET EASTERLY THEREFROM;  
THENCE WESTERLY TO A POINT OPPOSITE ENGINEERS STATION 279+50.00  
ON SAID CENTERLINE AND 60.00 FEET EASTERLY THEREFROM; THENCE  
NORTHERLY TO A POINT ON THE NORTHERN BOUNDARY OF SAID TRACT "X"  
OPPOSITE ENGINEERS STATION 281+60, MORE OR LESS, ON SAID  
CENTERLINE AND 60.00 FEET EASTERLY THEREFROM; THENCE WESTERLY  
ALONG SAID NORTHERN BOUNDARY TO THE NORTHWEST CORNER OF SAID  
TRACT "X" OPPOSITE ENGINEERS STATION 281+60, MORE OR LESS, ON  
SAID CENTERLINE AND 52.92 FEET EASTERLY THEREFROM; THENCE  
SOUTHERLY ALONG THE WESTERN BOUNDARY OF SAID TRACT "X" TO A  
POINT OPPOSITE ENGINEERS STATION 279+50, MORE OR LESS, ON SAID  
CENTERLINE AND 55.00 FEET EASTERLY THEREFROM; THENCE WESTERLY TO  
A POINT OPPOSITE ENGINEERS STATION 279+50, MORE OR LESS, ON SAID  
CENTERLINE AND 51.50 FEET EASTERLY THEREFROM; THENCE SOUTHERLY  
TO A POINT OPPOSITE ENGINEERS STATION 278+23.00 ON SAID  
CENTERLINE AND 53.50 FEET EASTERLY THEREFROM; THENCE EASTERLY TO  
THE POINT OF BEGINNING AND THE TERMINUS OF THIS LINE.

CONTAINING 2,776 SQUARE FEET MORE OR LESS.



**PARCEL 454**

**AURORA AVE N  
RIGHT OF WAY**

**02/11/10**

**EXHIBIT B page 11 of 14**

TRACT "X"

LOT 4, BLOCK 5 OF CLIVE'S ADDITION TO ECHO LAKE, ACCORDING TO  
THE PLAT THEREOF RECORDED IN VOLUME 15 OF PLATS, PAGE 5, IN KING  
COUNTY, WASHINGTON;

EXCEPT THAT PORTION THEREOF CONVEYED TO THE STATE OF WASHINGTON  
FOR STATE ROAD NO. 1 UNDER KING COUNTY RECORDING NUMBER 2173673.

 NCA ENGINEERS INC.	 ENGINEERING INC.	 CITY OF SHORELINE	PARCEL 454	02/11/10
			AURORA AVE N RIGHT OF WAY	

PARCEL 456

PERMANENT RIGHT-OF-WAY BEING A PORTION OF THE HEREINAFTER DESCRIBED TRACT "X" LOCATED IN THE NORTHWEST QUARTER OF THE SOUTHEAST QUARTER OF SECTION 6, TOWNSHIP 26 NORTH, RANGE 4 EAST, W.M., CITY OF SHORELINE, KING COUNTY, WASHINGTON; MORE PARTICULARLY DESCRIBED AS FOLLOWS:

ALL THAT PORTION OF TRACT "X" LYING SOUTHWESTERLY OF A LINE BEGINNING AT A POINT ON THE SOUTHERN BOUNDARY OF SAID TRACT "X" OPPOSITE ENGINEERS STATION 286+43.69 AND 64.00 FEET EASTERLY, MEASURED AT RIGHT ANGLES, THEREFROM THE CENTERLINE OF AURORA AVENUE NORTH SHOWN ON THAT SURVEY RECORDED UNDER AUDITOR'S FILE NUMBER 20080305900001, RECORDS OF KING COUNTY, WA; THENCE NORTHWESTERLY TO A POINT OPPOSITE ENGINEERS STATION 286+64.50 ON SAID CENTERLINE AND 50.00 FEET EASTERLY THEREFROM, SAID POINT BEING ON THE WESTERN BOUNDARY OF SAID TRACT "X" AND THE TERMINUS OF THIS LINE.

CONTAINING 145 SQUARE FEET MORE OR LESS.



<b>INCA</b> <small>INCA ENGINEERS INC.</small>	<b>HDR</b> <small>ENGINEERING INC.</small>	 <b>CITY OF SHORELINE</b>	<b>PARCEL 456</b> <b>AURORA AVE N</b> <b>RIGHT OF WAY</b>	<b>02/04/10</b>
---	---	---	---	-----------------

PARCEL 456

TEMPORARY CONSTRUCTION EASEMENT BEING A PORTION OF THE  
HEREINAFTER DESCRIBED TRACT "X" LOCATED IN THE NORTHWEST  
QUARTER OF THE SOUTHEAST QUARTER OF SECTION 6, TOWNSHIP 26  
NORTH, RANGE 4 EAST, W.M., CITY OF SHORELINE, KING COUNTY,  
WASHINGTON; MORE PARTICULARLY DESCRIBED AS FOLLOWS:

ALL THAT PORTION OF TRACT "X" LYING WITHIN A LINE BEGINNING  
AT A POINT OPPOSITE ENGINEERS STATION 286+43, MORE OR LESS,  
AND 213 FEET, MORE OR LESS, EASTERLY, MEASURED AT RIGHT  
ANGLES, THEREFROM ON THE CENTERLINE OF AURORA AVENUE NORTH  
SHOWN ON THAT SURVEY RECORDED UNDER AUDITOR'S FILE NUMBER  
20080305900001, RECORDS OF KING COUNTY, WA, SAID POINT BEING  
THE SOUTHEAST CORNER OF SAID TRACT "X"; THENCE WESTERLY  
ALONG THE SOUTHERN BOUNDARY OF SAID TRACT "X" TO A POINT  
OPPOSITE ENGINEERS STATION 286+43.69 ON SAID CENTERLINE AND  
64.00 FEET EASTERLY THEREFROM; THENCE NORTHWESTERLY TO A  
POINT ON THE WESTERN BOUNDARY OF SAID TRACT "X" OPPOSITE  
ENGINEERS STATION 286+64.50 ON SAID CENTERLINE AND 50.00  
FEET EASTERLY THEREFROM; THENCE NORTHERLY ALONG SAID WESTERN  
BOUNDARY TO A POINT ON THE NORTHERN BOUNDARY OF SAID TRACT  
"X" OPPOSITE ENGINEERS STATION 289+87, MORE OR LESS, ON SAID  
CENTERLINE AND 50.00 FEET EASTERLY THEREFROM; THENCE  
EASTERLY ALONG SAID NORTHERN BOUNDARY TO A POINT OPPOSITE  
ENGINEERS STATION 289+87, MORE OR LESS, ON SAID CENTERLINE  
AND 53.00 FEET EASTERLY THEREFROM; THENCE SOUTHERLY TO A  
POINT OPPOSITE ENGINEERS STATION 287+50.00 ON SAID  
CENTERLINE AND 53.00 FEET EASTERLY THEREFROM; THENCE  
EASTERLY TO A POINT OPPOSITE ENGINEERS STATION 287+50.00 ON  
SAID CENTERLINE AND 55.00 FEET EASTERLY THEREFROM; THENCE  
SOUTHERLY TO A POINT OPPOSITE ENGINEERS STATION 286+63.89 ON  
SAID CENTERLINE AND 55.00 FEET EASTERLY THEREFROM; THENCE  
SOUTHEASTERLY TO A POINT OPPOSITE ENGINEERS STATION  
286+46.09 ON SAID CENTERLINE AND 63.85 FEET EASTERLY  
THEREFROM; THENCE EASTERLY TO A POINT OPPOSITE ENGINEERS  
STATION 286+46.07 ON SAID CENTERLINE AND 153.88 FEET  
EASTERLY THEREFROM; THENCE NORTHERLY TO A POINT OPPOSITE  
ENGINEERS STATION 286+49.28 ON SAID CENTERLINE AND 153.91  
FEET EASTERLY THEREFROM; THENCE EASTERLY TO A POINT ON THE  
EASTERN BOUNDARY OF SAID TRACT "X" OPPOSITE ENGINEERS  
STATION 286+48.85, MORE OR LESS, AND 213 FEET EASTERLY  
THEREFROM; THENCE SOUTHERLY ALONG SAID EASTERN BOUNDARY TO  
THE POINT OF BEGINNING AND THE TERMINUS OF THIS LINE.

CONTAINING 1,812 SQUARE FEET MORE OR LESS.

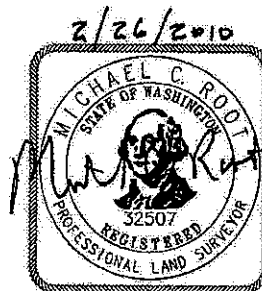

**INCA HDR**  
NCA ENGINEERS INC. ENGINEERING INC.



PARCEL 456

AURORA AVE N  
RIGHT OF WAY

02/26/10

**EXHIBIT B page 14 of 14**

TRACT "X"

LOT 2, BROGAN'S BINDING SITE PLAN, RECORDED UNDER RECORDING  
NUMBER 20060922000172 IN VOLUME 236 OF PLATS, PAGES 78  
THROUGH 82, INCLUSIVE, IN KING COUNTY, WASHINGTON;

EXCEPT THAT PORTION THEREOF DEEDED TO THE CITY OF SHORELINE  
BY DEED RECORDED UNDER RECORDING NUMBER 20080926001612.

 INCA ENGINEERS INC. HDR ENGINEERING INC.	 CITY OF SHORELINE	PARCEL 456	02/04/10
		AURORA AVE N RIGHT OF WAY	