

CITY COUNCIL AGENDA ITEM
CITY OF SHORELINE, WASHINGTON

AGENDA TITLE:	Authorize the City Manager to Execute an Interlocal Agreement With King County to Complete the 2002 Road Overlay Program for an Amount Not to Exceed \$700,000
DEPARTMENT:	Public Works
PRESENTED BY:	Paul Haines, Public Works Director Jesus Sanchez, Public Works Operations Manager

PROBLEM/ISSUE STATEMENT:

King County has paved City of Shoreline streets with asphalt overlay since the City's incorporation. To meet the County's schedule of beginning the overlay project in early summer, an interlocal agreement must be signed.

FINANCIAL IMPACT:

The 2002 Public Works Budget has \$700,000 allocated for this program.

RECOMMENDATION

Staff recommends that Council authorize the City Manager to execute an interlocal agreement with the King County Department of Roads and Transportation Division to complete the 2002 Overlay Program for an amount not to exceed \$700,000.

Approved By:

City Manager

LB

City Attorney

[Signature]

This page intentionally left blank.

INTRODUCTION

King County has paved City of Shoreline streets with asphalt overlay since the City's incorporation. To meet the County's schedule of beginning the overlay project in early summer, an interlocal agreement must be signed. Staff recommends that Council authorize the City Manager to execute an interlocal agreement with the King County Department of Roads and Transportation Division to complete the 2002 Overlay Program for an amount not to exceed \$700,000.

BACKGROUND

At a Council meeting on February 1, 1999, Public Works staff introduced the use and concept of Pavement Management systems. Staff presented a long-term strategy to optimize available funds, improve the overall condition of our pavement network and get more work done with limited funds. Council concurred that it would be necessary to increase the overlay budget of \$400,000 adopted during the 1999 budget process. During the 2000 budget preparation process, the Council decided to increase the total overlay budget to \$700,000, and to remain at this funding level for the immediate future.

Slurry Seal is not considered as part of our road maintenance program for 2002. The Slurry Seal application for the 2001 Overlay Program was not as successful due in part to the type of mix utilized. The Slurry Seal mix type III was not conducive to our Northwest climate for curing purposes. Slurry Seal treatment is an effective preventive maintenance application prolonging the life of surface roads, but the right combination of mix must be used to effect a good application in unique regions like the Northwest. Slurry Seal modeling of different types will be utilized and tested this year in preparation for inclusion in our 2003 road maintenance program.

Public Works staff has identified locations for the 2002 Overlay Project utilizing Measurement Research Corporation's Pavement Management System data. Our primary objective continues to be to effectively maintain or enhance the integrity of the City's roadway system in the most cost efficient manner. Staff is requesting your Council's approval to proceed with the identified overlay program. Due to the cost reductions of including our overlay as part of a larger contract, we would like to contract again this year with King County Department of Transportation, Roads Division for the overlay portion.

RECOMMENDATION

Staff recommends that Council authorize the City Manager to execute an interlocal agreement with the King County Department of Roads and Transportation Division to complete the 2002 Overlay Program for an amount not to exceed \$700,000.

ATTACHMENTS

- A: Project Map
- B: 2002 Overlay Project Streets

2002 Overlay Program

— 1-1/2" Overlay

— 1" Overlay

2002a overlay.shp
2002 overlay.shp
Road

Interstate
State Route
Principal Arterial
Minor Arterial
Collector Arterial
Residential Street

0 500 1000 1500 2000 2500 3000 3500 Feet
1" = 1800 feet



City of Shoreline GIS Cultural, Ortho Photo
building outlines, contour data copyright © by
City of Seattle, 1998. All rights reserved.
No warranties of any sort, including accuracy,
fitness, or merchantability, are made by the
product.

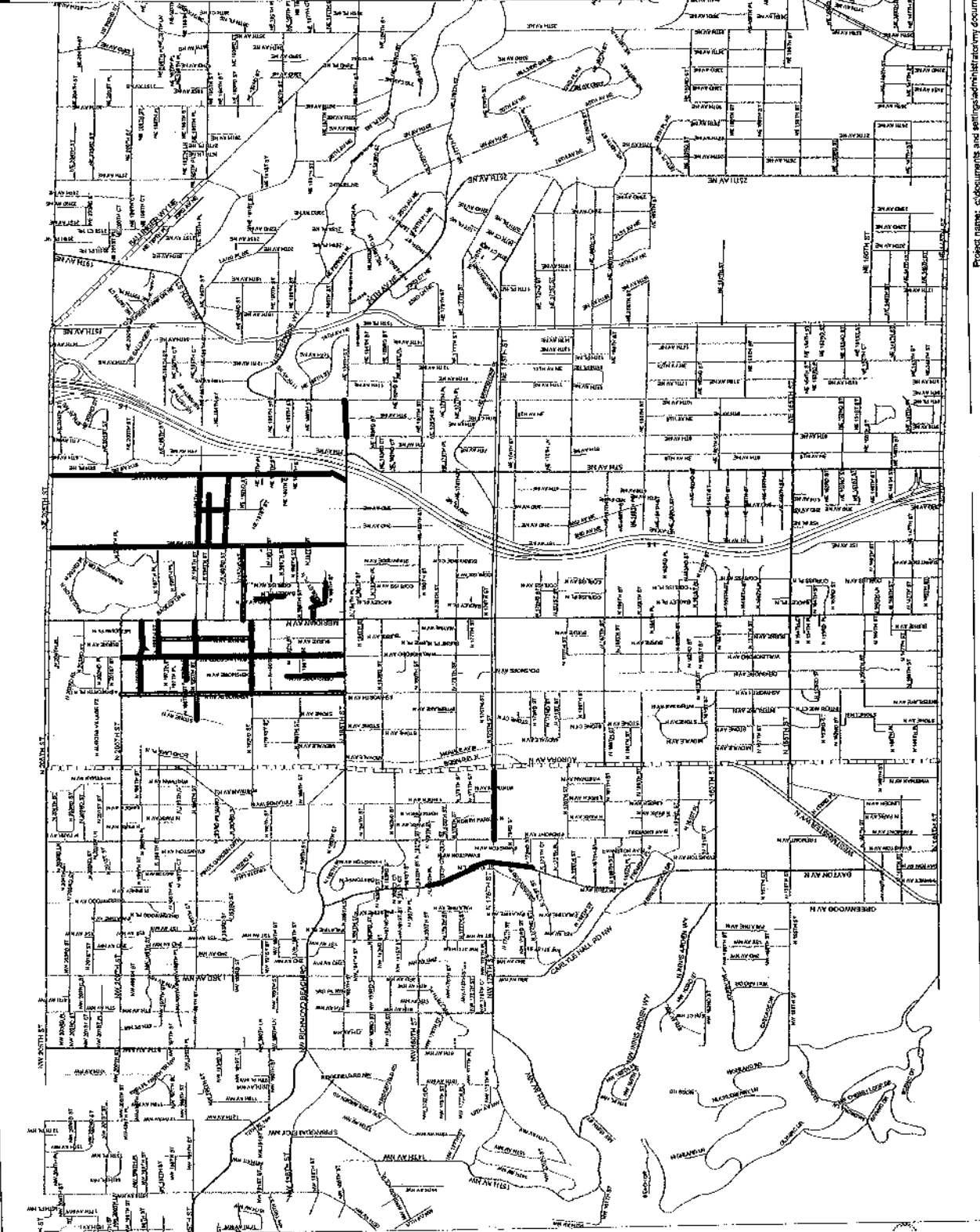

**CITY OF SHORELINE
2002 OVERLAY PROJECT**

ATTACHMENT B

STREET	FROM	TO	LENGTH	WIDTH	SQUARE YARDS	COST	COND. RATING
1 Ave NE	N 188 Street	N 190 Street	191	27	573	\$4,126	63
1 Ave NE	N 190 Street	N 192 Street	631	27	1,893	\$13,630	45
1 Ave NE	N 192 Street	NE 195 Street	815	20	1,811	\$13,040	30
1 Ave NE	N 187 Street	N 188 Street	258	26	745	\$5,366	55
1 Ave NE	NE 185 Street	NE 187 Street	604	31	2,080	\$14,979	55
1 Ave NE	NE 195 Street	NE 205 Street	2650	30	8,833	\$63,600	63
3 Ave NE	NE 195 Street	NE 193 Street	488	21	1,139	\$8,198	38
5 Ave NE	NE 195 Street	NE 185 Street	2660	20	5,911	\$42,560	62
5 Ave NE	NE 205 Street	NE 195 Street	2650	24	7,067	\$50,880	60
Bagley Ave N	N 190 Street	End Route (N)	240	26	693	\$4,992	45
Bagley PL N	N 187 Street	N 186 Street	151	26	436	\$3,141	67
Bagley PL N	N 190 Street	End Route (S)	249	26	719	\$5,179	18
Dayton Ave N	N 171 Street	N 172 Street	180	28	560	\$4,032	48
Dayton Ave N	N 172 Street	St. Luke Place	1,054	24	2,811	\$20,237	14
Dayton Ave N	St. Luke Place	N 179 Pl	838	32	2,980	\$21,453	58
Densmore Ave N	N 185 Street	End Route (N)	1071	20	2,380	\$17,136	45
N 192 Street	Meridian Ave N	Ashworth Ave N	1290	26	3,727	\$26,832	54
N 195 Street	Meridian Ave N	Wallingford Ave N	637	24	1,699	\$12,230	52
N 196 Pl	Wallingford Ave N	End Route (W)	425	25	1,181	\$8,500	35
N 199 Street	Meridian Ave N	Wallingford Ave N	254	29	818	\$5,893	63
N 199 Street	Wallingford Ave N	Ashworth Ave N	653	20	1,451	\$10,448	35
NE 194 Street	End Route (E)	1 Ave NE	587	20	1,304	\$9,392	15
NE 195 Street	5 Ave NE	1 Ave NE	1340	20	2,978	\$21,440	62
Wallingford Ave N	N 189 Street	N 185 Street	936	26	2,704	\$19,469	63
Wallingford Ave N	N 192 Street	N 189 Street	695	20	1,544	\$11,120	63
Wallingford Ave N	N 195 Street	N 192 Street	978	23	2,499	\$17,995	63
Wallingford Ave N	N 197 Pl	N 195 Street	508	26	1,468	\$10,566	35
Wallingford Ave N	N 199 Street	N 197 Pl	491	27	1,473	\$10,606	61
N 175th Street	Aurora Ave N	Linden Ave N	580	51	3,287	\$23,664	40
N 175th Street	Linden Ave N	Fremont Ave N	643	42	3,001	\$21,605	63
NE 185 Street	10 Ave NE	8 Ave NE	666	41	3,034	\$21,845	63
N 195 Street	Meridian Ave N	Wallingford Ave N	637	23	1,628	\$11,721	50

**CITY OF SHORELINE
2002 OVERLAY PROJECT**

ATTACHMENT B

STREET	FROM	TO	LENGTH	WIDTH	SQUARE YARDS	COST	COND. RATING
Wallingford Ave N	N 199 Street	N 200 Street	317	25	881	\$6,340	61
TOTAL			26,367		75,308	\$542,214	
Pavement Condition scale is from 0-100, with 0 being the worst condition and 100 being the best.							

**CITY OF SHORELINE
2002 OVERLAY PROJECT
1" THIN OVERLAY**

ATTACHMENT B

STREET	FROM	TO	LENGTH	WIDTH	SQUARE YARDS	COST	COND. RATING
Ahworth Ave N	N 185th Street	N 200th Street	3909	20	8,687	\$62,544	73
NE 193 Street	5 Ave NE	1 Ave NE	1340	31	4,616	\$25,386	75
NE 192 Street	1 Ave NE	Corliss Ave N	654	26	1,889	\$10,391	77
N 192 Street	Corliss Ave N	Meridian Ave N	646	22	1,579	\$8,685	71
Burke Ave N	N 192 Street	N 195 Street	978	21	2,282	\$12,551	69
Burke Ave N	N 195 Street	N 198 Street	664	20	1,476	\$8,116	75
N 186 Street	Bagley Pl N	Corliss Ave N	351	26	1,014	\$5,577	74
N 187 Street	Meridian Ave N	End Route (E)	441	26	1,274	\$7,007	74
N 195 Street	Ashworth Ave N	End Route (W)	663	20	1,473	\$8,103	70
N 198 Street	Meridian Ave N	Wallingford Ave N	645	22	1,577	\$8,672	74
TOTAL			10,291		25,866	\$157,032	
Pavement Condition scale is from 0-100, with 0 being the worst condition and 100 being the best.							