

Kirk McKinley

From: Sheldon, Matt [matt.shelden@soundtransit.org]
Sent: Wednesday, March 11, 2015 2:36 PM
To: Kirk McKinley
Cc: Sowers, Nytasha; Ginder, Michelle
Subject: 130th tradeoffs

Here are the slides re: 130th that we'll go over at the corridor leadership group on Monday.

Matt



Current preferred alternative near 130th St.



- At-grade under 130th St. bridge
- Requires re-building bridge, interchange and 5th Ave NE
- No station included, but leaves room for one
- WSDOT highway work on critical path
- High schedule risk

11

Change? Go over 130th St.

SOUND TRANSIT LYNNWOOD LINK EXTENSION

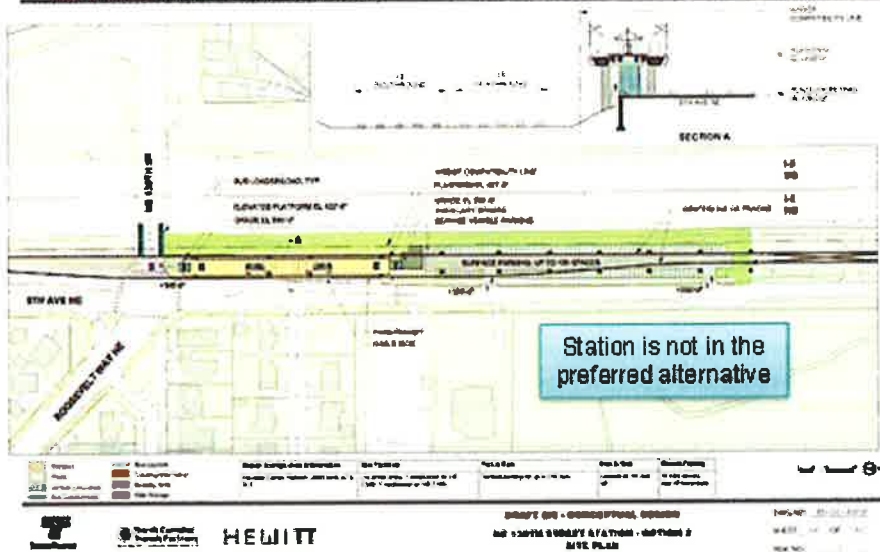

Pros	Cons
Avoids 130 th bridge & interchange rebuild & reduces WSDOT/FHWA complications & delay	Does not improve 130 th bridge or interchange (non-LRT benefit)
Takes WSDOT work off critical path	Increases visual impacts
Saves cost (~\$10M)	Does not add value to WSDOT land bank
Station is still possible (elevated)	
Reduces WSDOT P&R impact	

Current 145th St. station preferred alternative

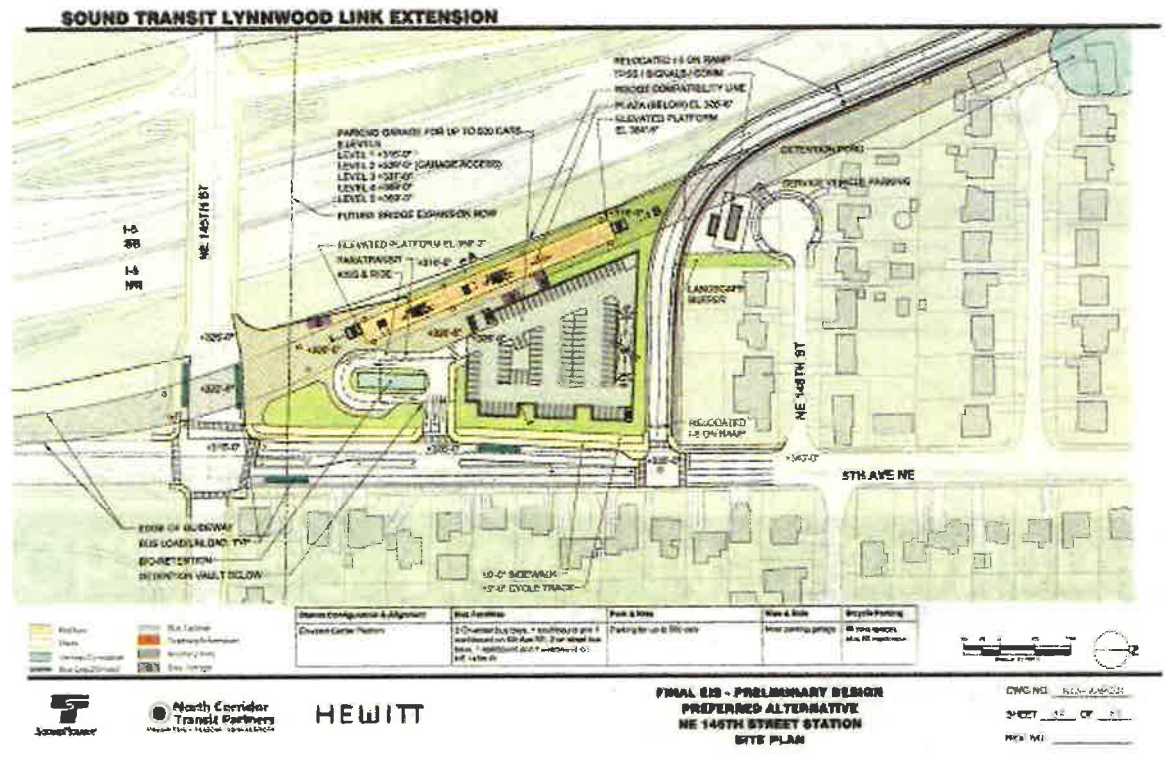

- Consolidates station close to 145th and minimizes property impacts
- Requires moving on-ramp to I-5
- Changes property access near interchange
- **Moderate FHWA approval risk**

Change? Move 145th station garage north

SOUND TRANSIT LYNNWOOD LINK EXTENSION

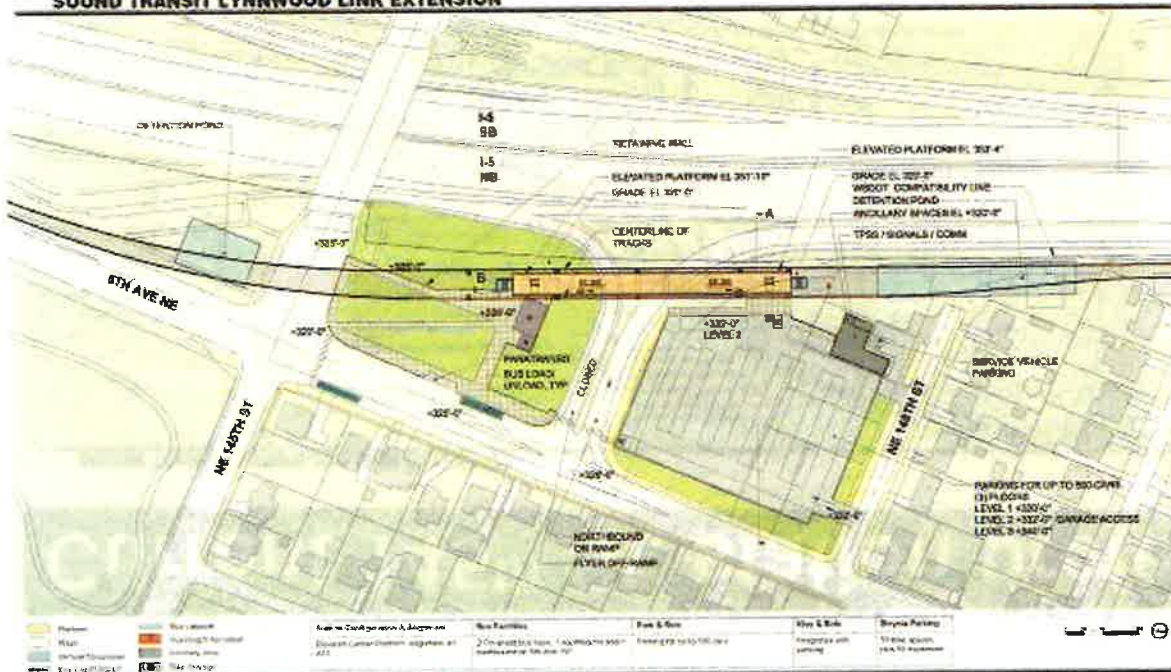

Pros	Cons
Avoids I-5 on-ramp relocation and WSDOT/FHWA complications	Station layout & connectivity is less desirable
Provides bigger, more flexible construction staging area	May require 3-4 more residential properties
	Acceptability of changed traffic control unknown



HEWITT

DRAFT 01B - CONCEPTUAL DESIGN
NE 145TH STREET STATION - OPTION 1
SITE PLAN

DATE: 09.10.2011
SHEET: 01 OF 10
REV: 01

Change? Move 185th garage east

SOUND TRANSIT LYNNWOOD LINK EXTENSION

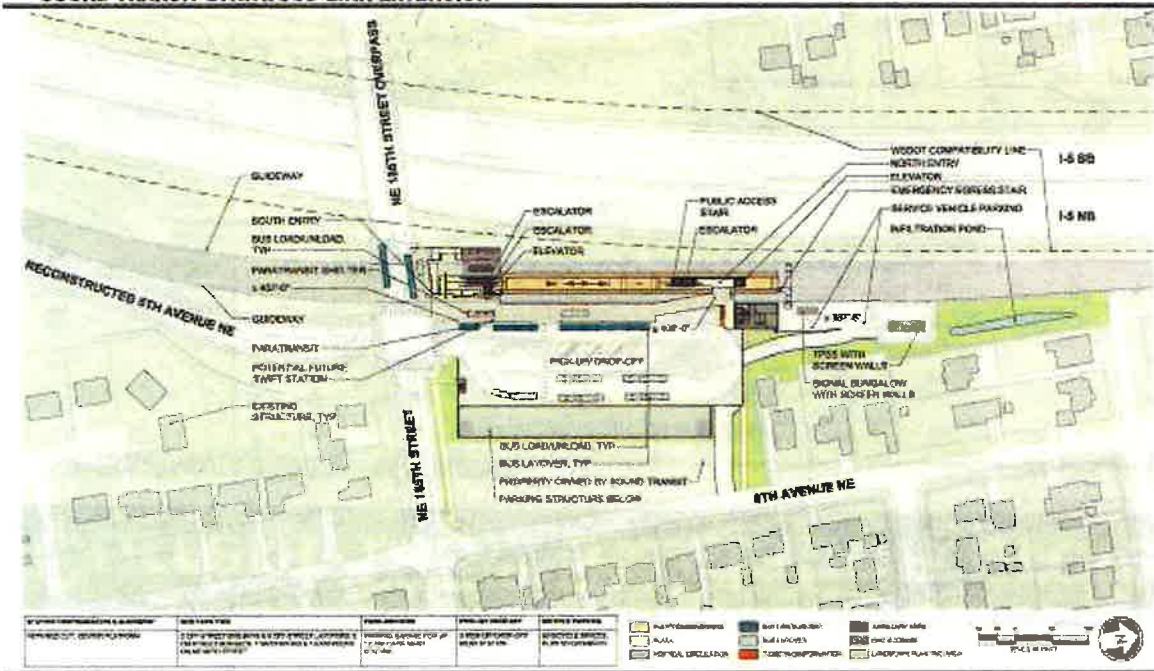

Pros	Cons
Reduces constraints on widening I-5	Garage may be more visible until adjacent land redevelops
Eliminates need to relocate 5 th Ave NE west of I-5	Slightly reduces land available for TOD next to station
Reduces need to modify NE 185 th bridge	Increases traffic on 8 th Ave NE
Saves cost (~\$1-2M)	
Improves garage access to station	



North Corridor
Transit Partners

HEWITT

FINAL EIS - PRELIMINARY DESIGN
NE 185TH STREET STATION
STATION AREA PLAN

DWG NO. NE 185TH STATION
SHEET OF
REV. NO.

